



## Back-lit Flat panel w/ 3CCT and wattage selectable



**Rouge Lighting Plus** back-lit flat panel series has a uniform and soft luminous efficiency, extreme energy saving, and environment friendly. The 3CCT and Wattage Selectable options includes 3500K, 4000K, 5000K at 110lm per watt it can be easily selected at the time of installation with 0-10V dimming is perfect for new construction applications or retrofitting existing fluorescent troffer fixtures with recessed installation, widely used in office spaces, education, major retail stores, and more.

**LED CHIP-** Use approved LM-80 SMD filling, maintains superior color consistency over time and temperature with our precise color management. Before delivery Every fixture is tuned as a complete system to the optimal color point, safeguarding fixture-to-fixture color consistency.

**HEAT SINK-** High quality aluminum frame with great heat dissipation and low light degradation

**OPTICAL SYSTEM-** The panel light has uniform and soft luminance, high luminous efficacy, saving energy besides protecting environment with viewing angle of 120°

**CURRENT SUPERVISION-** High quality driver, efficiency>86%, PF>0.9 are attached directly to the housing which keeps the engines cool. Our innovative current supervision system allows the light output of the LED engines to be maintained at 80% of initial lumen at Lifespan >50,000 hours of operation.

**WARRANTY-** 5 YEARS LIMITED WARRANTY

**LISTING-** ETL

**DIMMING-** 0-10V dimming can be well compatible with all kinds of brand dimmers.

**ELECTRICAL-** Driven by high-quality constant-current power LED drivers which are rated for 50 to 60Hz at input Voltage 120-277V input, and output current of 1000mA produce less than 20% THD and consume a power factor of .90 to 1.00.

**MAINTENANCE-** Zero distance between back cover and the frame protect against dust perfectly. MS material cannot use in places like hospital, kitchens with heavy dust and over 12 hours continuously; PMMA material is not restricted in the above environment.

**OPTIONS-** Fixtures can be shipped pre-installed with occupancy sensors daylight harvesting controls, and/or power pack. Available manufacturer options include Lutron, Leviton, Wattstopper, and others.

**QUALITY CONTROL-** Every fixture is tested and looked at before shipment.

## ORDERING INFORMATION

LUMINAIRE	LENGTH	OPTICS	WATTAGE 110lm/Watt	CONTROL OPTOINS	VOLTAGE	CRI	COLOR TEMP	FINISH	INSTALL ACCS.	OPTIONS
EFP - LED Flat Panel	14 - 1' x 4'	blank - (120°)	MW- 1x4, 2x2 20W,30W, 40W	blank - 0-10V, PWM	blank - 100-277V	blank - 80 CRI	3CCT - 3500K 4000K 5000K	blank - White	blank - T-bar Mount	EM - Emergency Ballast
	22 - 2' x 2'				347 - 100-347V					SMK - Surface Mount
	24 - 2' x 4'		MW - 2X4 30W,40, 50W		FKIT - Recessed Mount Flange Kit					DLH - Daylight Harvesting

(specify control  
or occupancy  
manufacture &  
part number )

**Back-lit Flat panel w/ 3CCT and wattage selectable**

**Product Features**

- 1.The panel light is mainly used in commercial lighting places, such as office, factory, supermarket and so on.
- 2.The panel light has uniform and soft luminance, high luminous efficacy, saving energy and protecting environment.
- 3.Using principle of back-lit, the panel light is extremely beautiful.
- 4.Using high quality material, with great heat dissipation and low light degradation.
- 5.Using high quality driver, efficiency>86%, PF>0.9.
- 6.Lifespan>50,000 hours.
- 7.0-10V dimming function dimming driver.
- 8.Dustproof: Zero distance between back cover and the frame protect against dust perfectly.
- 9.No yellowing problem of Light Guided Plate for this panel light.
- 10.Connect the AC wire and DC wire of the driver input separately.
- 11.CCT Adjustable range: 3500K-4000K-5000K.
- 12.Power Adjustable range;

**Specification**

Product Model	Power	Working Current	Input Voltage	Luminous Efficacy	CCT	Viewing Angle	Ra	Dimmable	Warranty
EFP22-MW-3CCT	20W/30W/40W	0.44A	AC100-277V	110lm/W	3500K   4000K   5000K	120°	≥80	0-10V	5 years
EFP14-MW-3CCT	20W/30W/40W	0.44A							
EFP24-MW-3CCT	30W/40W/50W	0.55A							
EFP22-MW-3CCT-HL	20W/30W/40W	0.44A	AC100-277V	125lm/W					
EFP14-MW-3CCT-HL	20W/30W/40W	0.44A							
EFP24-MW-3CCT-HL	30W/40W/50W	0.55A							
EFP22-MW-347-3CCT	20W/30W/40W	0.44A	AC100-347V	110lm/W					
EFP14-MW-347-3CCT	20W/30W/40W	0.44A							
EFP24-MW-347-3CCT	30W/40W/50W	0.55A							
EFP22-MW-347-3CCT-HL	20W/30W/40W	0.44A	AC100-347V	125lm/W					
EFP14-MW-347-3CCT-HL	20W/30W/40W	0.44A							
EFP24-MW-347-3CCT-HL	30W/40W/50W	0.55A							

**Back-lit Flat panel w/ 3CCT and wattage selectable**

**Installation Instruction**

1. Unscrew the driver cover.

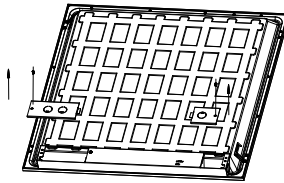

2. Connect the conduit to the driver box.

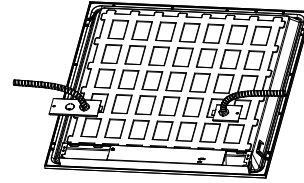

3. Connect other wires separately.

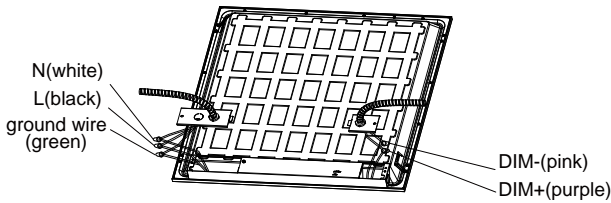

4. Put back the driver cover and fix it by screw.

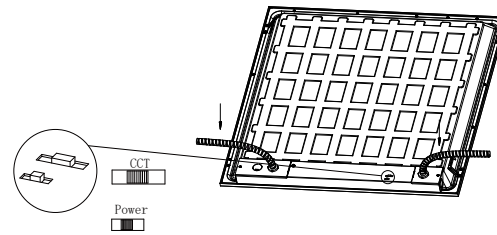

\* Optional accessories  
 If there are more wires, you can choose to use enlarged junction box.

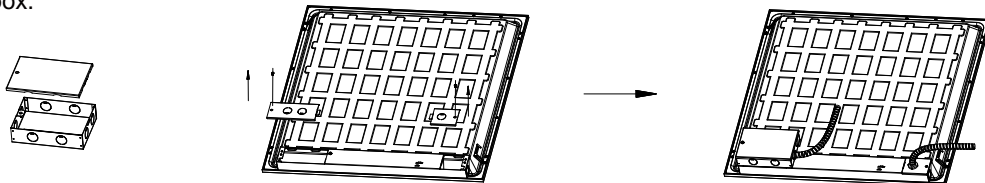

**Recessed Installation**

1. Replace existing lighting fixture from ceiling with LED Panel.

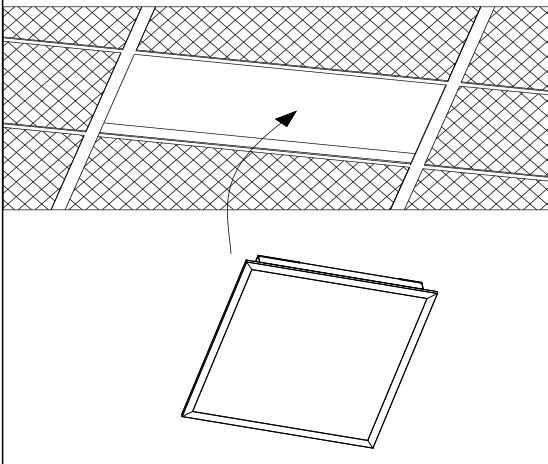

2. Use the protective brackets for the sake of safety.

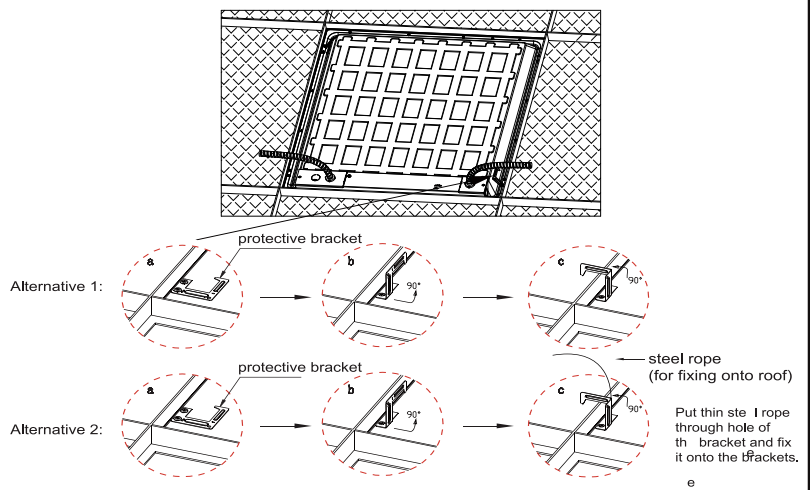

**Back-lit Flat panel w/ 3CCT and wattage selectable**

**Product Dimension**

